



# COMHAIRLE NAN EILEAN SIAR

The Town and Country Planning Scotland Act 1997 – Section 36(1)

Town and Country Planning General Development Procedure Order 2013 Regulation 16

Planning Register - Part 1

## Application Details

Reference Number	24/00052/PPP
Date registered as valid	08/02/24
Description of Development	Erect House
Address or description of location to which the development relates	9A Vatisker, Back, Isle of Lewis
Co-ordinates	E148627 N939724
Applicant Name	Mr Donald Macleod
Applicant Address	5 Cathrine Grove, Bo'ness, EH51 9UA
Agent name (if applicable)	Total Design (Lighthill) Ltd Per Mr David Macleod
Agent address (if applicable)	Balard, 68 Lighthill, Back, Isle of Lewis, HS2 0LF

**The above application summary is accompanied by plans and drawings sufficient to describe the development and where relevant any design statement.**

Important Note: on Tuesday 07 November 2023, Comhairle nan Eilean Siar experienced a criminal cyber incident and is working with Police Scotland, the Scottish Government and the National Cyber Security Centre to investigate the matter.

The Online Planning Portal remains unavailable as does our suite of integrated software and hardware systems. In order to enable access by the wider public to application documents and consult upon planning applications, interim systems have been put in place on the temporary website of Comhairle nan Eilean Siar, including a rudimentary facility to display a limited number of documents per application.

Any party wishing to view the application file in full may do so at the offices of Comhairle nan Eilean Siar at Sandwich Road, Stornoway Isle of Lewis, HS1 2BW or Balivanich, Isle of Benbecula. HS7 5LA, ordinarily between 9am and 5pm Monday to Friday (excluding public and local holidays). It is recommended that in advance of visiting an office to view an application that you make an appointment by sending an email to [planning@cne-siar.gov.uk](mailto:planning@cne-siar.gov.uk)

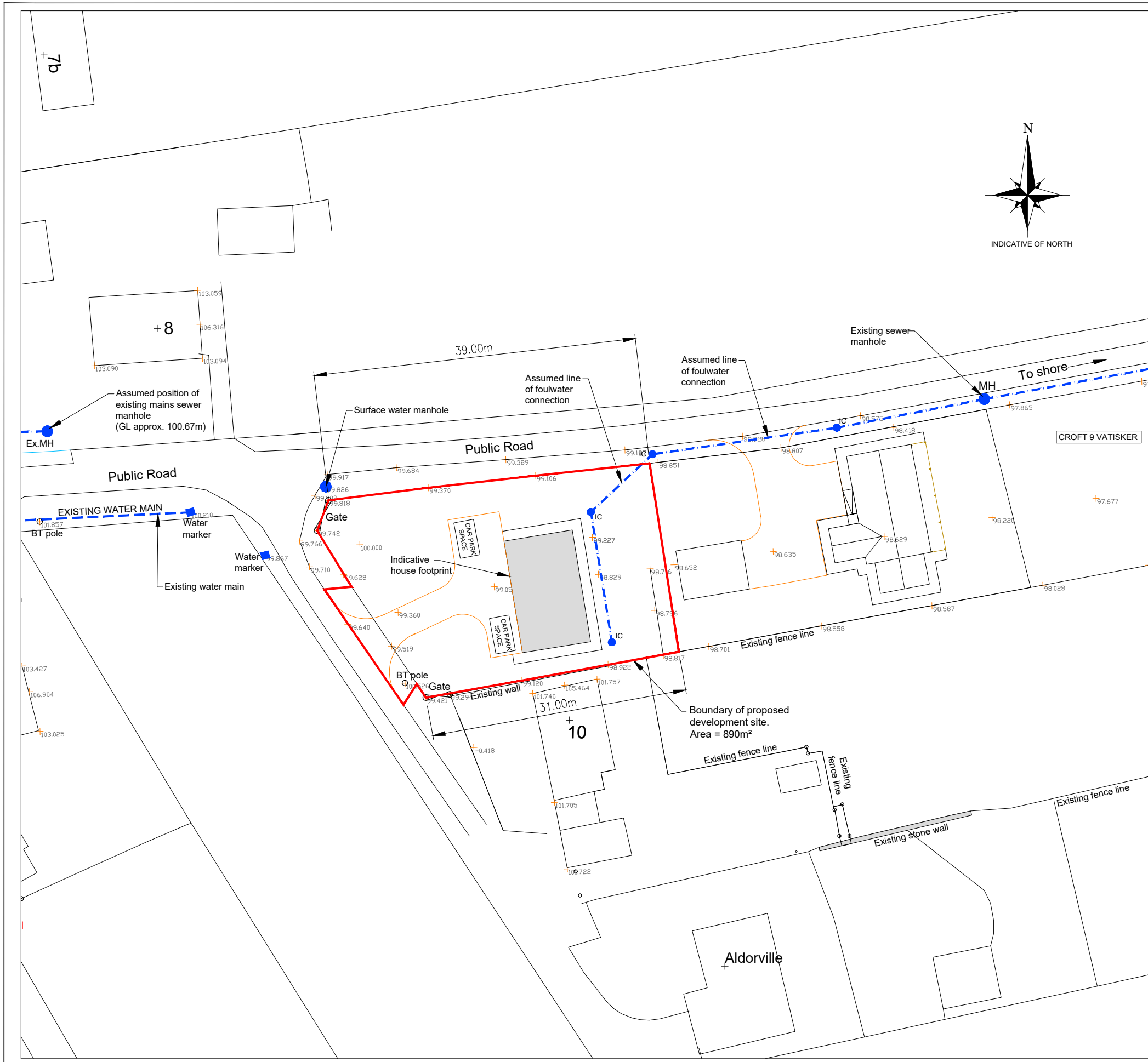

**SITE PLAN**  
SCALE 1:500

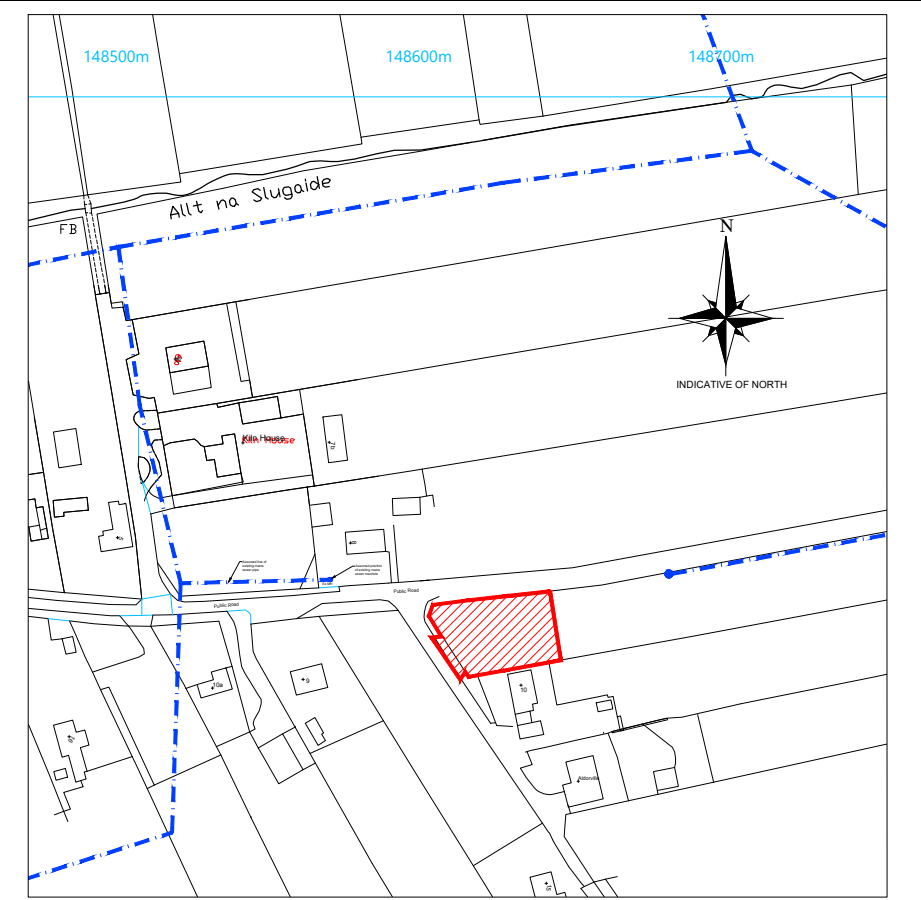
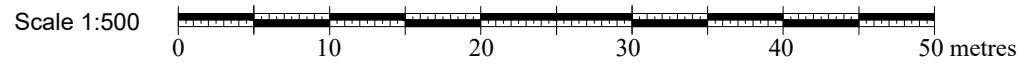

**LOCATION PLAN**  
SCALE 1:2500

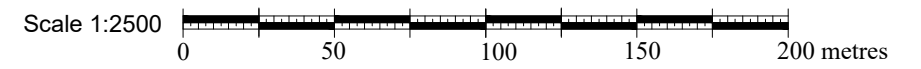

**LEGEND**

- DC = Disconnecting chamber (min 450mm)
- IC = Inspection chamber
- MH = Manhole
- RE = Rodding eye
- ± = Spot level (m)
- [Green box] = rainwater drainage (110mm PVCu pipes) to outfall into soakaway (min. 1m x 3m x 0.5m dp)
- [Blue dashed line] = 150mm PVCu foulwater pipe
- [Green dashed line] = 110mm PVCu rainwater pipe
- [Blue dashed line] = water pipe
- [Blue square] WT Water toby

**Notes:**

- 1) This drawing to be read in conjunction with the relevant specification and all other relevant drawings.
- 2) All dimensions and levels to be checked on site and any discrepancies identified prior to commencement of work.
- 3) All dimensions in metres unless otherwise noted.
- 4) All levels in metres unless otherwise noted. Levels relative to a TBM of 100m at survey station 1000.
- 5) It is the responsibility of the applicant to inform landowners and seek the necessary permission(s) for the proposed foulwater route.
- 6) It is the responsibility of the applicant/owner to undertake the necessary trial holes to establish if ground conditions are suitable along the extent of the foulwater pipe line.

FOR APPROVAL

Rev	By	Chkd	Apprvd	Date	Description

**TOTAL DESIGN (LIGHTHILL) LTD**  
 Ballard, 68 Lighthill,  
 Back Lane of Lewis  
 HS2 0LF  
 Tel: 01851 827 137 Mob: 07917 806 013 Email: totaldesign@sky.com

**Applicant:**  
**Mr & Mrs Macleod**

Project **PLANNING IN PRINCIPLE**  
**9b Vatisker,**  
**Isle of Lewis**

**SITE AND LOCATION PLANS**

Drawn by: D MacLeod Date: 31.01.24

Checked by: Date:

Approved by: - Date: -

Drawing No. **S690-PPP-001** Revision **00**

Drawing Scale: AS NOTED @ A3