

SPANNROHR LINKS/RECHTS  
TURNBUCKLE LEFT/ RIGHT

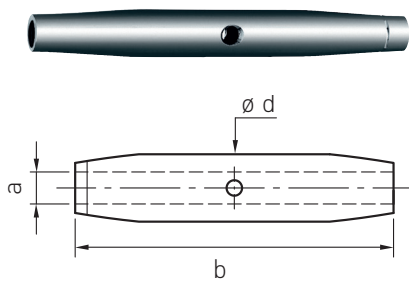

Artikelnummer Part number	a	b	$\varnothing d$
875-0500	M5	80	8
875-0600	M6	92	10
875-0800	M8	112	13,5
875-1000	M10	120	17,2
875-1200	M12	150	21,3
875-1400	M14	170	21,3
875-1600	M16	190	26,9
875-2000	M20	220	33,7
875-2400	M24	328	50

**Werkstoff 1.4401**  
Material AISI 316

**Alle Angaben in Millimetern**  
All dimensions in millimeters