

GEWINDESTIFT  
THREADED ROD

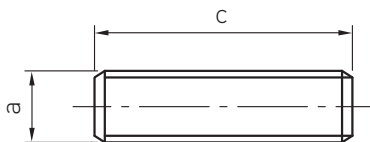
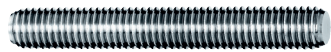

Artikelnummer Rechtsgewinde Part number RH thread	Artikelnummer Linksgewinde Part number LH thread	a	c
882-0500-060	883-0500-060	M5	60
882-0500-100	883-0500-100	M5	100
882-0600-060	883-0600-060	M6	60
882-0600-100	883-0600-100	M6	100
882-0600-1000	883-0600-1000	M6	1000
882-0800-060	883-0800-060	M8	60
882-0800-120	883-0800-120	M8	120
882-0800-220	883-0800-220	M8	220
882-0800-1000	883-0800-1000	M8	1000
882-1000-040	-	M10	40
882-1000-060	883-1000-060	M10	60
882-1000-1000	883-1000-1000	M10	1000
882-1200-040	-	M12	40
882-1200-080	883-1200-080	M12	80
882-1200-180	-	M12	180
882-1200-220	883-1200-220	M12	220
882-1200-1000	883-1200-1000	M12	1000
882-1600-080	883-1600-080	M16	80

**Werkstoff 1.4401**  
Material AISI 316

**Alle Angaben in Millimetern**  
All dimensions in millimeters