

This box contains:

- PrecisionHD 1080p 12X camera
- Lens hood
- Power supply 12Vdc
- Mains power cable
- HDMI cable (5m / 16ft)
- VISCA camera control cable (5m / 16ft), RJ45 to DB9
- Daisy chaining cable, RJ11 to RJ45

1 We recommend that you mount the lens hood to prevent stray light from disturbing your video experience.

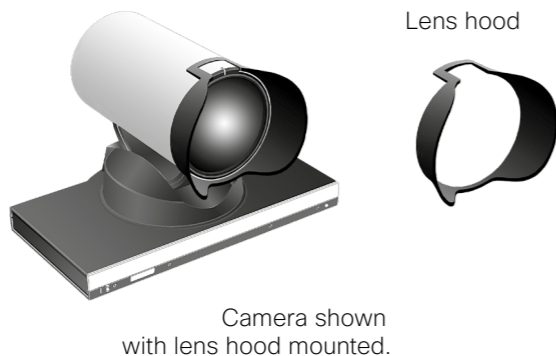

2 Turn the camera upside down to check the video output format setting. Alter the setting if needed.

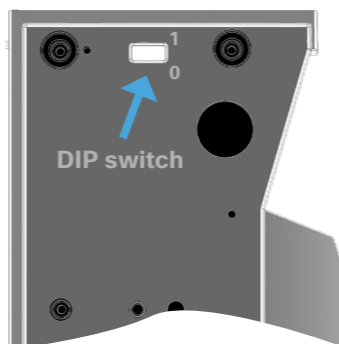

DIP switch table for video formats					HDMI	HD-SDI
1	2	3	4	5		
0	0	0	0	0	Auto	Auto
0	0	0	0	1	1080p25	1080p25
0	0	0	1	0	1080p30	1080p30
0	0	0	1	1	1080p50	720p50
0	0	1	0	0	1080p60	720p60
0	0	1	0	1	720p25	720p25
0	0	1	1	0	720p30	720p30
0	0	1	1	1	720p50	720p50
0	1	0	0	0	720p60	720p60
0	1	0	0	1	Software control	Software control

The table shows the different settings available for the HDMI and the HD-SDI outputs.

Auto: Camera negotiates format over HDMI. HD-SDI tracks HDMI and defaults to 1080p30 in absence of HDMI sync.

Software: For more information about the Software control setting, consult the VISCA™ commands in the PrecisionHD camera user guide.

3 Connect the camera to your codec. If you connect to a C-series codec, the power will be supplied from the codec and the camera power supply will not be needed.

VISCA™ commands

The VISCA™ commands for controlling the camera are described in the PrecisionHD camera user guide.

VISCA™ is a trademark of Sony Corporation.

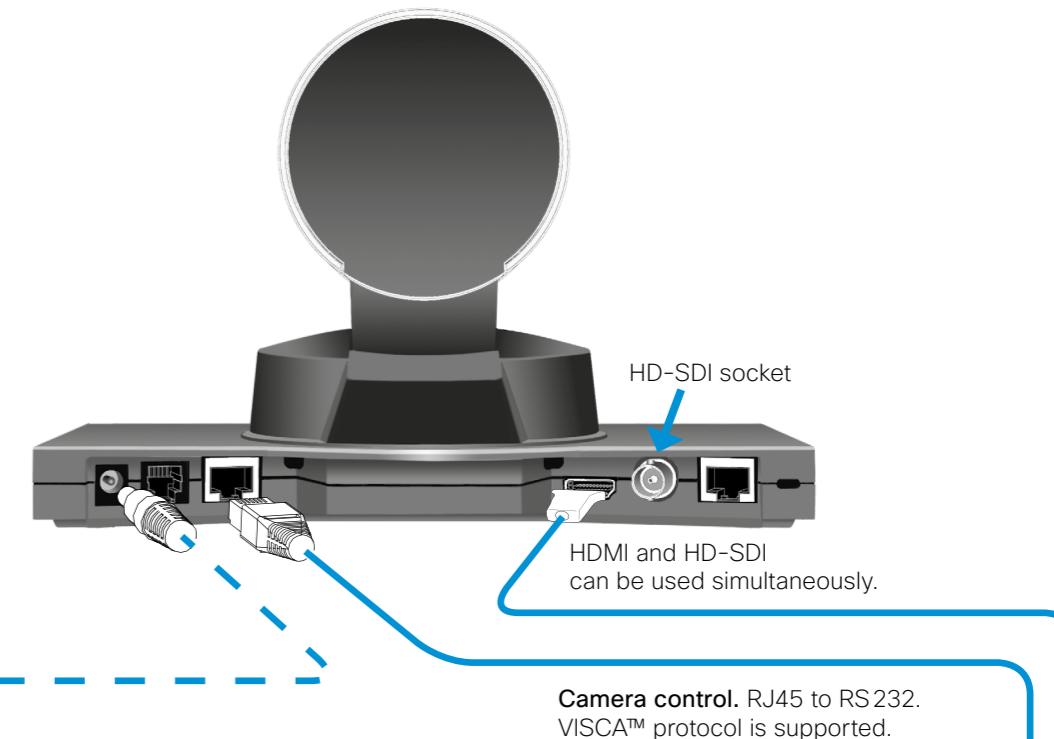

Codec C40 is used for illustration only. The connectors may be placed differently on other codecs.



EMC Class A declaration

声明

此为A级产品，在生活环境中，该产品可能会造成无线电干扰。在这种情况下，可能需要用户对其干扰采取切实可行的措施。

WARNING: This is a class A product. In a domestic environment this product may cause radio interference in which case the user may be required to take adequate measures.

The rear panel sockets

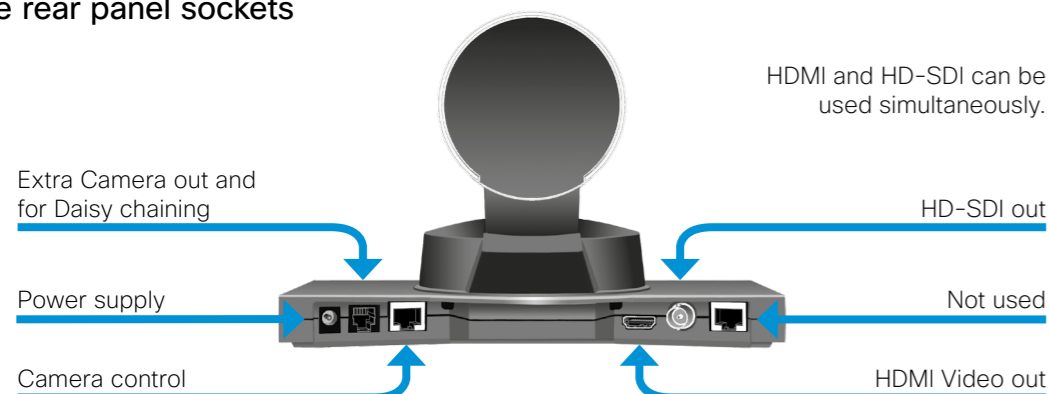

Daisy chaining cameras

Example. Shown here are four PrecisionHD 1080p 12X cameras in cascade, connected to four HDMI video input connectors of a C-series codec.

HDMI and HD-SDI. HDMI and HD-SDI can be used simultaneously on the same camera.

Power. The first camera in the chain gets its power from the codec through the VISCA camera control cable. Additional cameras must use the 12Vdc Power in.

Daisy chaining cable. The daisy chained cameras are connected by using the daisy chaining cable between the **Daisy chain out** and **Codec control in** sockets.

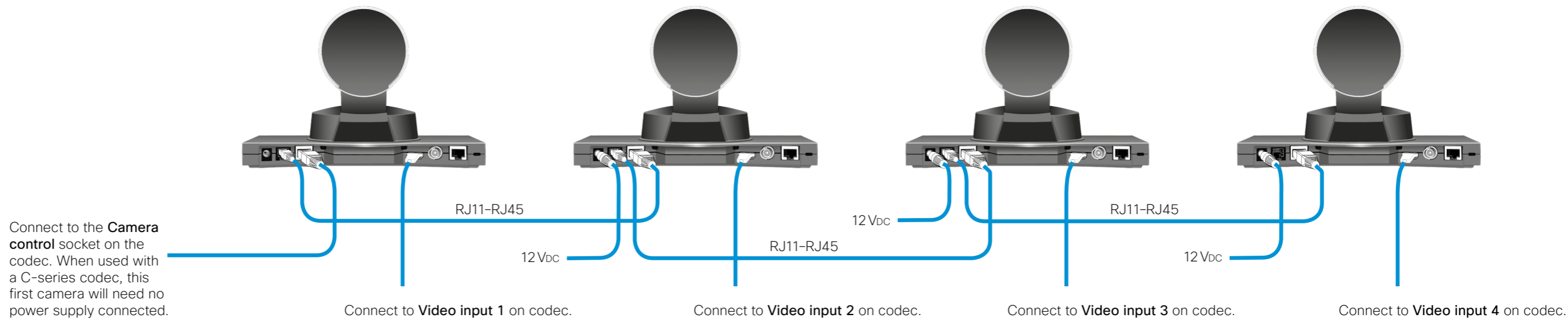

Mounting the camera upside down

The camera may also be mounted upside down. This may bring camera and monitor closer together and thus contribute to a better feeling of eye-contact between the video meeting participants.

The orientation of the camera is automatically detected when the camera is powered—no manual setup is required in order to display the image correctly on screen.



User documentation

The user documentation for this product is found on the Cisco web site. Go to: <http://www.cisco.com/go/telepresence/docs>

For details about how to connect PrecisionHD cameras to different codecs, see the camera user guide on: http://www.cisco.com/en/US/products/ps11335/products_user_guide_list.html