

## Mix and Match Blocks

Four really useful patchwork blocks have been created for you to make a wide range of lovely items. There is a flower, a leaf, a bee and a bird for you to play with. Including their borders, the motifs all create blocks of the same size, 13in x 12in (33cm x 30.5cm), so it is easy to combine them and mix and match to your heart's content. To provide ideas to get you going we have designed some quilts using these blocks – the Flower Meadow Quilt, the Flowers and Bees Quilt and the Adore You Baby Quilt. The quilts use fabrics mostly from the Happy Campers and Meadow Basics collections but you could easily use fabrics from other Tilda ranges. All of the instructions for the blocks and the quilts are available from [www.tildasworld.com](http://www.tildasworld.com).

### The Flower Block

In the Happy Campers quilts, the Flower block is used in six different colourways. Only one version of the block is described here. For the specific fabrics and the total fabric quantities to use, refer to the quilt instructions.

### Materials

- A solid fabric for the background (see **Fig B** for sizes to cut)
- Three print fabrics

### Making a Flower Block

1 The Flower block is used in six colourways in the Flower Meadow Quilt, in four colourways in the Flowers and Bees Quilt and in four colourways in the Adore You Baby Quilt. The layout is shown in **Fig A**. This diagram also shows fabrics but these will need to change depending on the project you are making. Follow **Fig B** carefully to cut the pieces needed for a block.

### Fig A Flower fabric layout

The fabrics will need to change depending on the project you are making

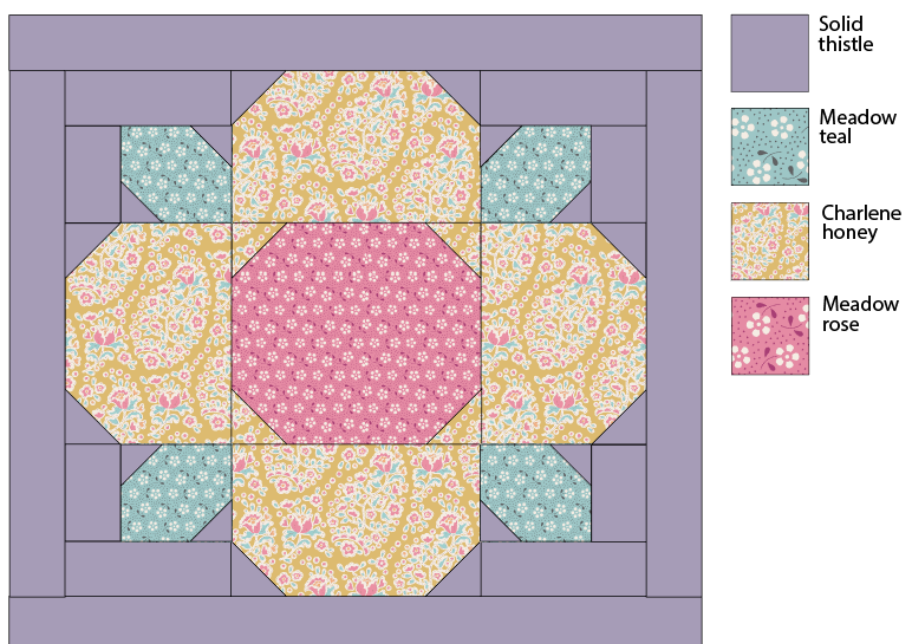

**Fig B** Layout and cutting for a Flower block

Sizes include seam allowances

All pieces to be cut as squares or rectangles

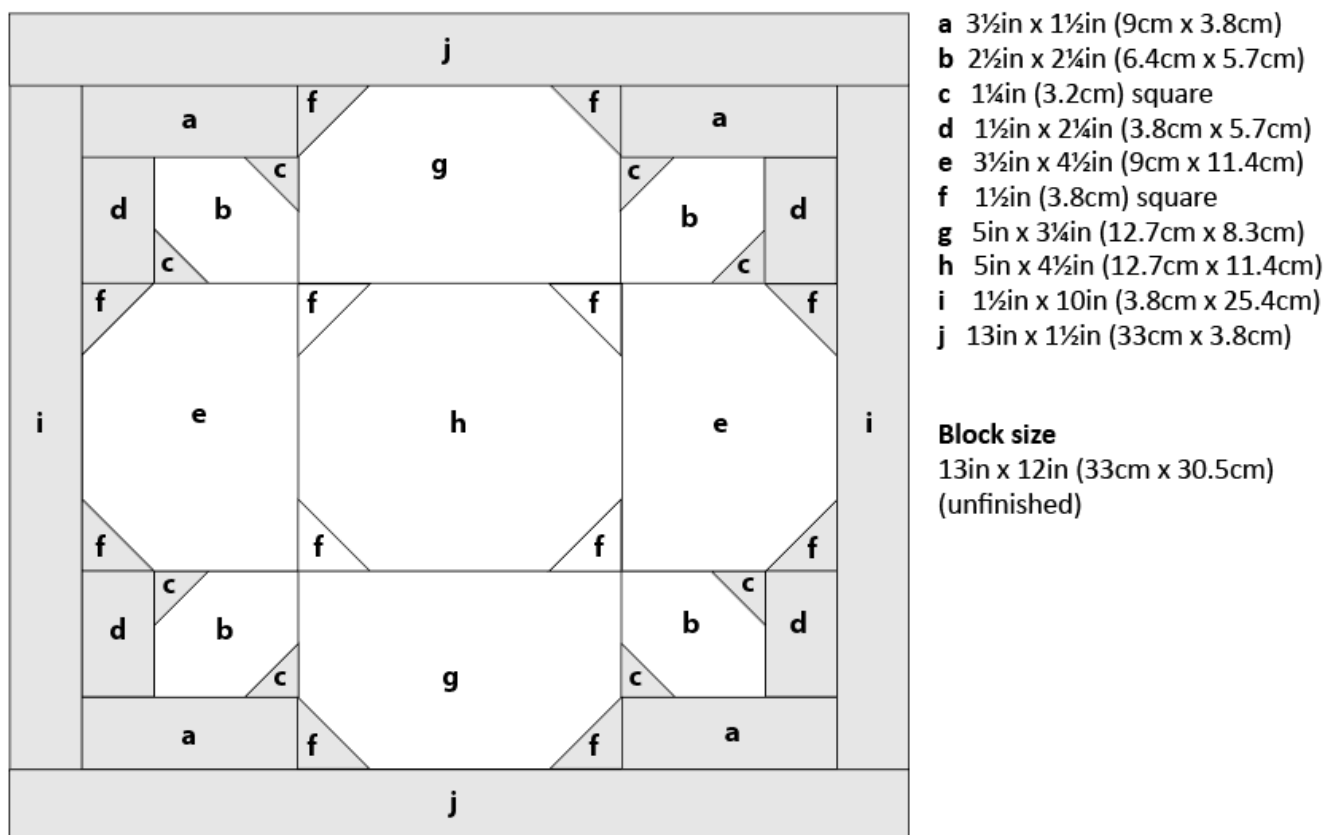

**2** Begin by making an **a**, **b**, **c**, **d** unit as follows. Take a **b** rectangle and two **c** squares. Pencil mark a diagonal line on the wrong side of the small squares and place the squares right sides together with two of the corners of the rectangle, with the marked lines angled as shown in **Fig C**. Pin if needed and then sew along the marked lines and trim off excess fabric ¼in (6mm) outside the sewn lines. Press the triangles outwards.

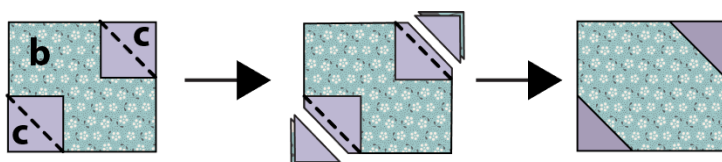
**Fig C** Making corner triangles

**3** Now sew one **d** rectangle to the left-hand side of the unit, as in **Fig D 1** and press, and then sew piece **a** to the top and press. Make another unit exactly like this.

**4** Make two more units like this, but this place the triangles in the opposite corners of the rectangle, as in **Fig D 2**, and then add the **a** and **d** pieces in the positions shown. Make another unit exactly like this.

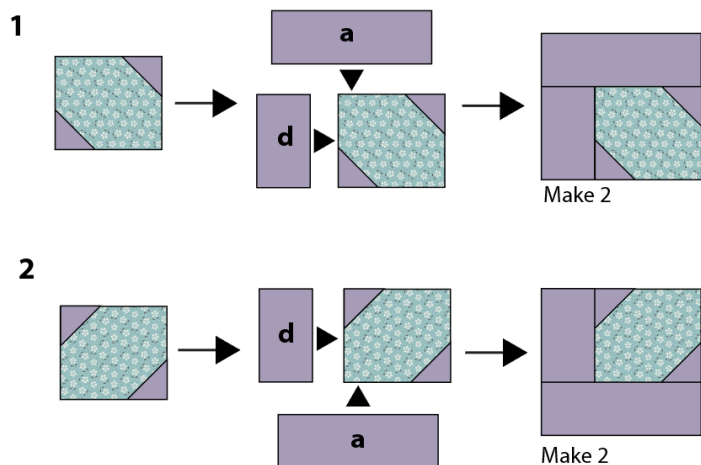
**Fig D** Completing the leaf units

**5** Use this same triangle corner method to make the petal units for the flower, using a **g** rectangle and two **f** squares (**Fig E**). Make four units like this.

Use the same triangle corner method to make the centre unit for the flower, using an **h** rectangle and four **f** squares.

**Fig E** Making the petals and flower centre

**6** To assemble the flower, take the nine units and arrange them as in **Fig F**. Sew the units together into three rows of three units. Press the seams of row 1 and row 3 in the opposite direction to row 2. Now sew the rows together, matching seams neatly, and press.

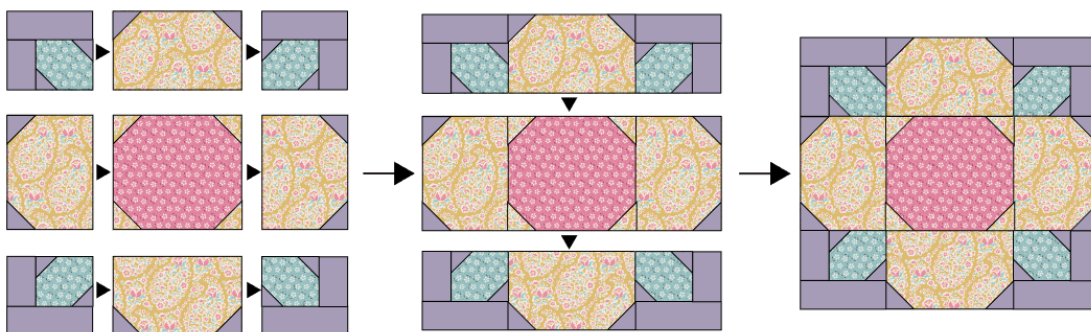
**Fig F** Assembling the flower units

7 To add a border to the block take the **i** pieces and sew them to the sides of the block and press. Now sew the **j** pieces to the top and bottom of the block (**Fig G**). Check that the block is 13in x 12in (33cm x 30.5cm).

**Fig G** Adding the border

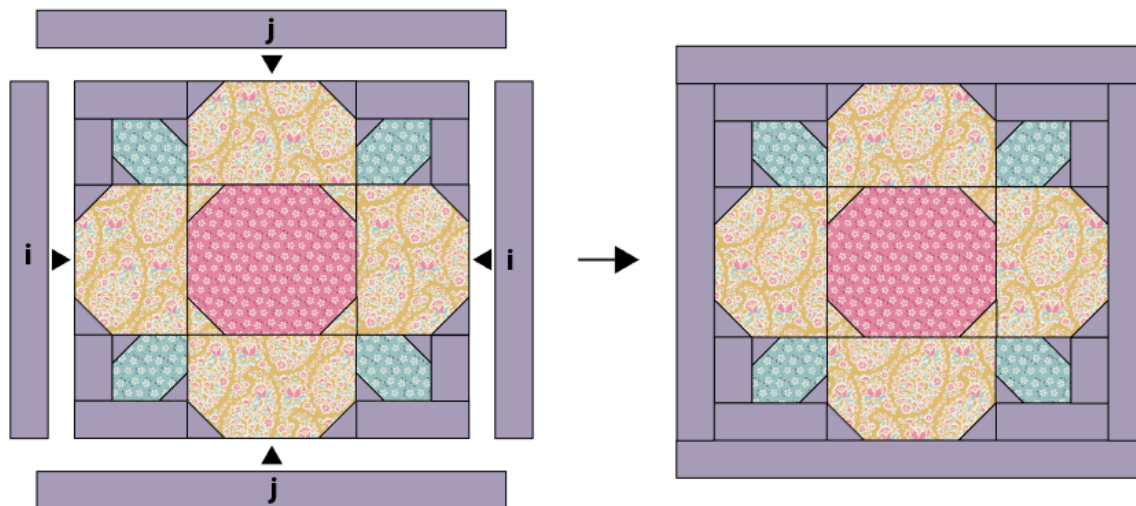

**Tip**

If creating your own projects using the Mix and Match blocks, you can change the outer border sizes. This will allow you to make the border deeper if you wish, or change the fabric, or even create a pieced border.