



Mufficorn!



Gnome with muffin and heart by @muffi_corn

skill level: intermediate

ENGLISH (US terms)



Mufficorn!

@muffi_corn

This pattern is FOR PERSONAL USE ONLY.

No part of this pattern may be resold, published, translated, reproduced in any form.

You can publish the photos and sell the toys, crocheted with the help of this pattern, but please credit [@muffi_corn](#) as the designer.

Follow us on Instagram [@muffi_corn](#) for more pictures and inspiration.

Please use [#mufficorn_crochet](#) to share your finished works.

Feel free to ask any questions regarding the pattern via mufficornetsy@gmail.com

I wish you to spend a good time with crocheting the **Gnome**.

Materials and instruments

- Yarn of the same weight (2 fine, sport, baby, 4 Ply).
 - White (Scheepjes Catona, Color 106, 50g/125m/136,5yds, 100% cotton)
approximately 30 g.
 - Light brown (Scheepjes Catona, Color 179, 50g/125m/136,5yds, 100% cotton)
approximately 25 g.
 - Pink (Scheepjes Catona, Color 222, 50g/125m/136,5yds, 100% cotton)
approximately 45 g.
- Stuffing material - fiberfill (holofiber) approximately 60 g.
- Crochet hook size 2.25mm (US: B/1, UK: 13)
- Yarn needle
- Scissors
- Stitch marker
- 30 beads (diameter 3 mm), 15 beads (diameter 6 mm)

Abbreviations

st(s)	stitch(es)	dec	decrease 2 sc together
rnd(s)	round(s)	inc	increase 2 sc in same st
MR	magic ring	dc	double crochet
ch	chain	hdc	half double crochet
slst	slip stitch	[]...*	repeat instructions in brackets N times
sc	single crochet	(...)	total number of stitches
FLO	front loop only	{ }	refers to the same element
BLO	back loop only	FO	fasten off

Useful tips

FO the hole.

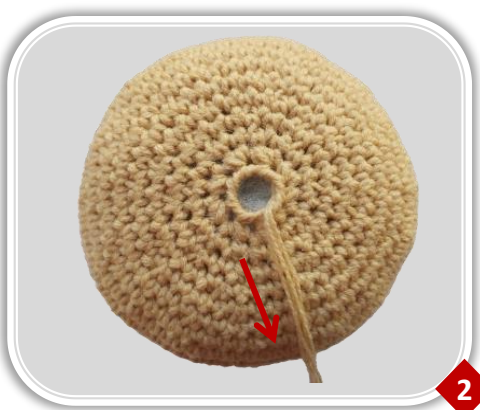

- 1 Weave needle through the last stitches FLO.
- 2 Pull tightly to close.
- 3 FO and hide the tail of the yarn inside the detail.

Invisible FO.



Yarn analogs (Yarn weight - 2 fine, sport, baby, 4 Ply)

Cotton + polyacryl - Kartopu Amigurumi, Alize Cotton Gold, Yarn Art JEANS, Gazzal JEANS

100% Cotton - Schachenmayr Catania, Distrifil Caline, DMC Natura Just Cotton, Gazzal Giza Matte, Gazzal Giza

* The size of the product depends on the yarn and hook you have chosen.

If you are using the same materials, your finished toy should be approximately:

Gnome - 18 cm (7 inch)

Muffin - 6 cm (2 1/4 inch)

Heart - 3 cm (1 1/8 inch)

* Use a marker at the beginning of the row.

* Pay attention to recommendations for crochet density. Crochet density of the details is medium.

Hat + Body

Pink yarn

Icing

Crochet in a continuous round (in a spiral).

Start stuffing as you go.

Stuff firmly.

rnd

1	6 sc in MR	(6)
2	sc in each st around	(6)
3	[1 sc , inc] *3	(9)
4	sc in each st around	(9)
5	[2 sc , inc] *3	(12)
6	sc in each st around	(12)
7	[2 sc , inc] *4	(16)
8-9	sc in each st around	2rnds (16)
10	[3 sc , inc] *4	(20)
11-12	sc in each st around	2rnds (20)
13	[4 sc , inc] *4	(24)
14-15	sc in each st around	2rnds (24)
16	[5 sc , inc] *4	(28)
17-18	sc in each st around	2rnds (28)
19	[6 sc , inc] *4	(32)
20-21	sc in each st around	2rnds (32)
22	[7 sc , inc] *4	(36)
23-24	sc in each st around	2rnds (36)
25	[8 sc , inc] *4	(40)
26-27	sc in each st around	2rnds (40)
28	[9 sc , inc] *4	(44)
29-30	sc in each st around	2rnds (44)
31	[10 sc , inc] *4	(48)

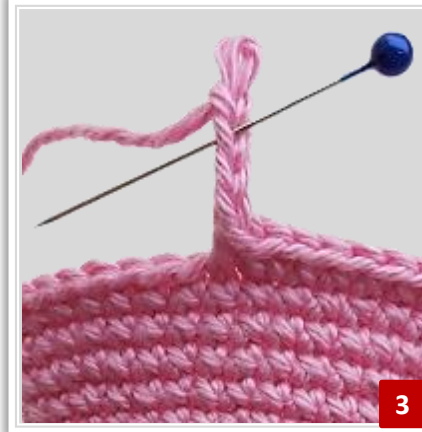

32	FLO in each st around	1	2	Video tutorial here https://youtu.be/m5yAyNjVXkU
	[in the same st: sc, {4 ch, start in the second chain from the hook	3	3 hdc	4 }, sc;
	3sc,	5		
	in the same st: sc, {6 ch, start in the second chain from the hook		5 hdc}, sc;	
	3sc]	6	*6,	7

Cut the yarn. FO.

Change to White yarn

32	BLO sc in each st around	(48)	8
33	sc in each st around	(48)	
34	[11 sc , inc] *4	(52)	
35-36	sc in each st around	2rnds (52)	

37	[12 sc , inc]	*4	(56)
38-39	sc in each st around	2rnds	(56)
40	FLO sc in each st around		(56)
41	[13 sc , inc]	*4	(60)
42	[14 sc , inc]	*4	(64)
43	[15 sc , inc]	*4	(68)
44	[16 sc , inc]	*4	(72)
Cut the yarn. Invisible FO.			
Continue crochet with Pink yarn			
40-41	BLO sc in each st around	2rnds	(56)
42-45	sc in each st around	4rnds	(56)
46	[13 sc , inc]	*4	(60)
47-50	sc in each st around	4rnds	(60)
51	[14 sc , inc]	*4	(64)
52-53	sc in each st around	2rnds	(64)
54	[6 sc , dec]	*8	(56)
55-57	sc in each st around	3rnds	(56)
58	[5 sc , dec]	*8	(48)
59-60	sc in each st around	2rnds	(48)
61	BLO sc in each st around		(48)
62	[4 sc , dec]	*8	(40)
63	[3 sc , dec]	*8	(32)
64	[2 sc , dec]	*8	(24)
65	[1 sc , dec]	*8	(16)
66	dec	*8	(8)

Cut the yarn. FO the hole.

11



9



7



8



10

If you want the sides of the icing fit to the hat you may, to your choice, sew or glue them or steam them and shape properly.



Beard

White yarn

Crochet in a continuous round (in a spiral).

Don't stuff.

rnd

1	6 sc in MR	(6)
2	2 sc, 2 inc, 2 sc	(8)
3	2 sc, 4 inc, 2 sc	(12)
4	[2 sc , inc] *4	(16)
5	[3 sc , inc] *4	(20)
6	[4 sc , inc] *4	(24)
7	[3 sc , inc] *6	(30)
8-12	sc in each st around	5rnds (30)
13	[3 sc , dec] *6	(24)
14	sc in each st around	(24)
15	[10 sc , dec] *2	(22)
16	sc in each st around	(22)

Cut the yarn.

Leave a long tail for sewing.

Invisible FO.

Sew the beard to the body in the center
in round 41 FLO.



Nose

Light brown yarn

Crochet in a continuous round (in a spiral).

Stuff firmly.

rnd

1	8 sc in MR	(8)
2	[1 sc, 2 inc, 1 sc] *2	(12)
3	[2 sc, 2 inc, 2 sc] *2	(16)
4-5	sc in each st around	2rnds (16)
6	dec *8	(8)

Cut the yarn.

Leave a long tail for sewing.

FO the hole.

Sew the nose in the center to the top of the beard.



Arms (make 2)

Light brown yarn

Crochet in a continuous round (in a spiral).

Don't stuff.

rnd

1	6 sc in MR	(6)
2	[1 sc , inc] *3	(9)
3-4	sc in each st around	2 rnds (9)
5	[dec, 7 sc]	(8)
Change to Pink yarn		
6-13	sc in each st around	8 rnds (8)

Cut the yarn.

Leave a long tail for sewing.

Invisible FO.

Do another one.

Sew the arms symmetrically on the sides of the body in round 41 FLO.



Muffin

Pink yarn

Icing

Crochet in a continuous round (in a spiral).

Start stuffing as you go.

Stuff firmly.

rnd

1	6 sc in MR	(6)
2	inc *6	(12)
3	[1 sc , inc] *6	(18)
4	[2 sc , inc] *6	(24)
5	[3 sc , inc] *6	(30)
6	[4 sc , inc] *6	(36)
7	[5 sc , inc] *6	(42)
8	[6 sc , inc] *6	(48)
9	FLO in each st around	1



[in the same st: sc, {4 ch, start in the second chain from the hook **2** 3 hdc **3** }, sc; **4**

3sc ,

in the same st: sc, {6 ch, start in the second chain from the hook 5 hdc}, sc;

3sc] **5** *6, **6**

Video tutorial here

<https://youtu.be/m5yAyNJVXkU>

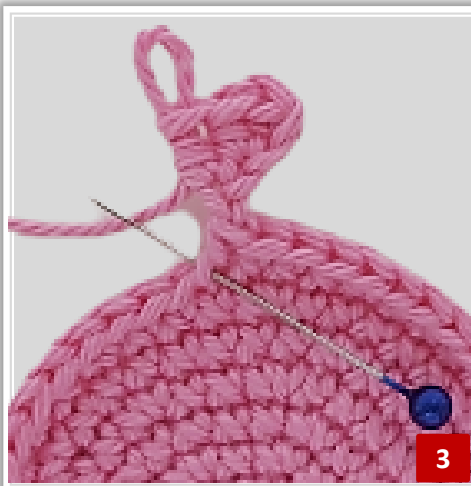

Change to Light brown yarn			
9	BLO sc in each st around	(48)	7
10	[7 sc , inc]	*6 (54)	
11	[8 sc , inc]	*6 (60)	
12	[9 sc , inc]	*6 (66)	
13	[10 sc , inc]	*6 (72)	
14-17	sc in each st around	4rnds (72)	
18	[2 sc , dec]	*18 (54)	
19-23	sc in each st around	5rnds (54)	
24	[7 sc , dec]	*6 (48)	
25-29	sc in each st around	5rnds (48)	
30	BLO sc in each st around	(48)	
31	[4 sc , dec]	*8 (40)	
32	[3 sc , dec]	*8 (32)	
33	[2 sc , dec]	*8 (24)	
34	[1 sc , dec]	*8 (16)	
35	dec	*8 (8)	

Cut the yarn.

FO the hole.

If you want the sides of the icing fit to the muffin you may, to your choice, sew or glue them or steam them and shape properly.



Hearts (make 2)

White yarn

Crochet in a continuous round (in a spiral).

rnd

1	6 sc in MR	(6)
2	inc *6	(12)
3	[1 sc , inc] *6	(18)
4	stitches of round:	

Stitch 1: sc

Stitch 2: 2hdc in same st

Stitch 3-4: 2dc in same st

Stitch 5: 2hdc in same st

Stitch 6: hdc

Stitch 7-8: sc

Stitch 9: 2sc in same st, 2ch

Stitch 10: 2sc in same st **1**

Stitch 11-12: sc

Stitch 13: hdc

Stitch 14: 2hdc in same st

Stitch 15-16: 2dc in same st

Stitch 17: 2hdc in same st

Stitch 18: sc



Hide the end of the yarn backside.

2 **3**

FO. **4**

Do another one.

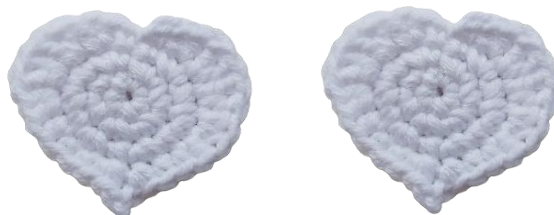

Connect 2 pieces with White (Red) yarn.

Video tutorial here

<https://youtu.be/IsAR8V-8B9Q>

Step 1. Insert hook BLO from outside to inside (from right to left).

5

6

Step 2. Insert hook BLO from outside to inside (from left to right).

5

6

Step 3. Yarn over. 7

Step 4. Draw the yarn through the 3 loops on the hook. 8

Start stuffing as you go.

Stuff firmly.

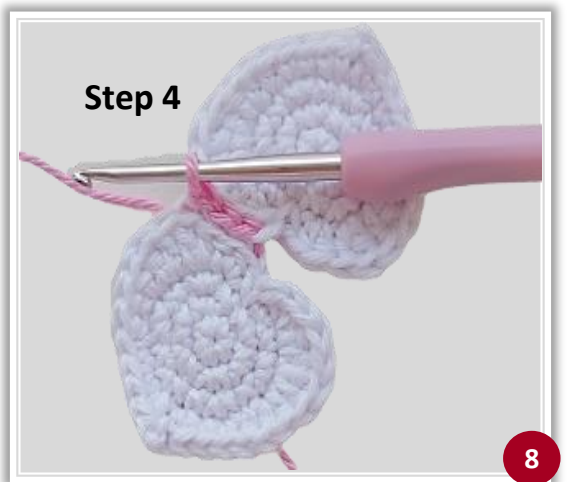
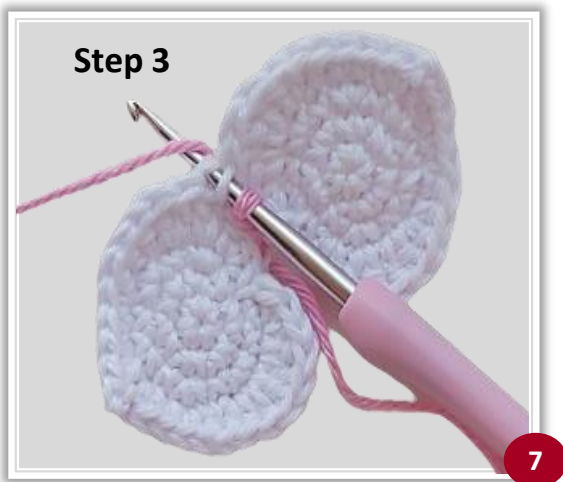
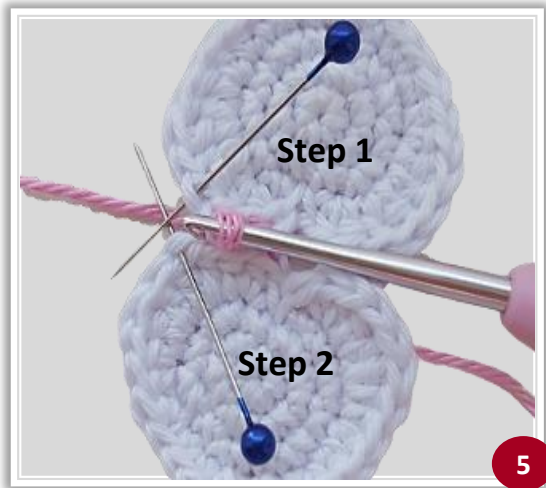

You can use beads to decorate muffin and gnome's hat.

If you wish, you can sew or glue the hearts to the muffin and gnome's hat.

